



NOTICE OF PUBLIC HEARING REGARDING DESIGNATION OF A JOHNSON COUNTY REINVESTMENT ZONE

The Commissioners Court of Johnson County will conduct a Public Hearing for the purpose of receiving public comment and voting in regards to designation of a Johnson County Reinvestment Zone. The proposed zone consists of the following properties described more particularly as follows:

All that certain 200.0 acre tract of parcel of land out of the Maria Turner Survey, Abst. No. 825, Johnson County, Texas, being that 200.0 acre tract conveyed by deed to Lake Comanche Ranch, LTD, as recorded in Book 2672, Page 921, Official Public Records of Johnson County, Texas.

The Public Hearing will be conducted on Monday, September 18th 2017, at 9:00am, at the Johnson County Courthouse, Commissioners Court, Room 210, 2 North Main St., Cleburne, Texas 76033.

FIELD NOTES

A survey of all that certain 200.0 acre tract of land out of the Maria Turner Survey, Abst. No. 825, Johnson County, Texas, being a portion of that 116.858 acre tract and a portion of that 126.823 acre tract conveyed by deed to Harold Collum, et ux, as recorded in Volume 915, Page 124 and in Volume 915, Page 129, respectively, Deed Records of Johnson County, Texas, and being more particularly described as follows:

- BEGINNING at a nail found in place in County Road No. 316, for a corner, said corner being the Most Northerly Northeast corner of said Collum 116.858 acre tract;
- THENCE -- S 01°30'E with an EAST line of said 116.858 acre tract, at 17.6 feet pass a steel rod found in place at a corner fence post for a reference, in all 964.1 feet with a fence line to a steel rod found in place at a corner fence post, for a corner;
- THENCE -- S 80°33'E 386.5 feet with a fence line and a NORTH line of said 116.858 acre tract to a steel rod found in place at a corner fence post, for a corner;
- THENCE -- S 26°34'E 1517.8 feet with a fence line and an EAST line of said 116.858 acre tract to a steel rod found in place at a corner fence post, for a corner;
- THENCE -- N 55°53'E 533.4 feet with a fence line and a SOUTH line of said 116.858 acre tract to a steel rod found in place at a corner fence post, for a corner;
- THENCE -- S 25°15'E 1691.57 feet with a fence line and the EAST line of said 116.858 acre tract and of said 126.823 acre tract to a steel rod found in place at a corner fence post, for a corner;
- THENCE -- S 59°14'W 2190.3 feet with a fence line and a SOUTH line of said 126.823 acre tract to a steel rod found in place at a corner fence post, for a corner;
- THENCE -- S 23°38'E 21.9 feet with a fence line to a steel rod found in place, for a corner;
- THENCE -- S 60°08'W 358.8 feet with a fence line and a SOUTH line of said 126.823 acre tract to a steel rod found in place, for a corner;
- THENCE -- N 30°47'19"W 4293.93 feet with a fence line and a WEST line of said 126.823 acre tract to a steel rod found in place, for a corner;
- THENCE -- N 56°26'36"E 649.6 feet with a fence line and a NORTH line of said 126.823 acre tract to a steel rod found in place at a corner fence post, for a corner;
- THENCE -- N 30°45'W with a WEST line of said 126.823 acre tract and a fence line, at 926.03 feet pass a steel rod found in place at a corner fence post for a reference, in all 970.03 feet to a steel rod found in place on the NORTH side of said road, for a corner;
- THENCE -- EAST 116.38 feet with the NORTH line of said 126.823 acre tract and said road to a nail set, for a corner;
- THENCE -- S 30°45'E, at 18.0 feet pass a steel rod set in a fence line for a reference, in all 1011.41 feet to a steel rod set, for a corner;
- THENCE -- S 56°26'36"W 349.8 feet to a steel rod set, for a corner;
- THENCE -- S 30°48'E 1297.23 feet to a steel rod set, for a corner;
- THENCE -- N 60°03'31"E 1146.05 feet to a steel rod set, for a corner;
- THENCE -- N 30°48'W 761.23 feet to a steel rod set, for a corner;
- THENCE -- N 07°30'48"W, at 942.7 feet pass a steel rod set in a fence line and in the SOUTH line of said road for a reference, in all 959.2 feet to a nail set in said road and in the NORTH line of said 116.858 acre tract, for a corner;
- THENCE -- EAST 500.0 feet with said road and the NORTH line of said 116.858 acre tract to the place of BEGINNING, containing 200.0 acres of land, of which approximately 0.28 acre lies within the county road.

I do hereby certify that this represents the results of a survey made on the ground by me and that there are no encroachments, conflicts or protrusions apparent on the ground except as shown hereon.

LEGEND

- Steel Rod
- ⊙ Steel Post
- Iron Pipe
- Conc. Mon.

Witness my hand and seal of office this 10th day of July 2001.

J.W. Maberry
J.W. Maberry
Registered Professional
Land Surveyor No. 1734

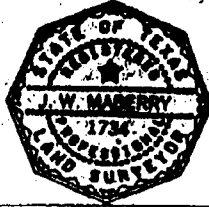

J.W. MABERRY
REGISTERED PROFESSIONAL LAND SURVEYOR
5900 Pecan Circle Alvarado, Texas 76009
Phone No. 817-790-8534 Job No. 2001-127

Project Mustang Zone

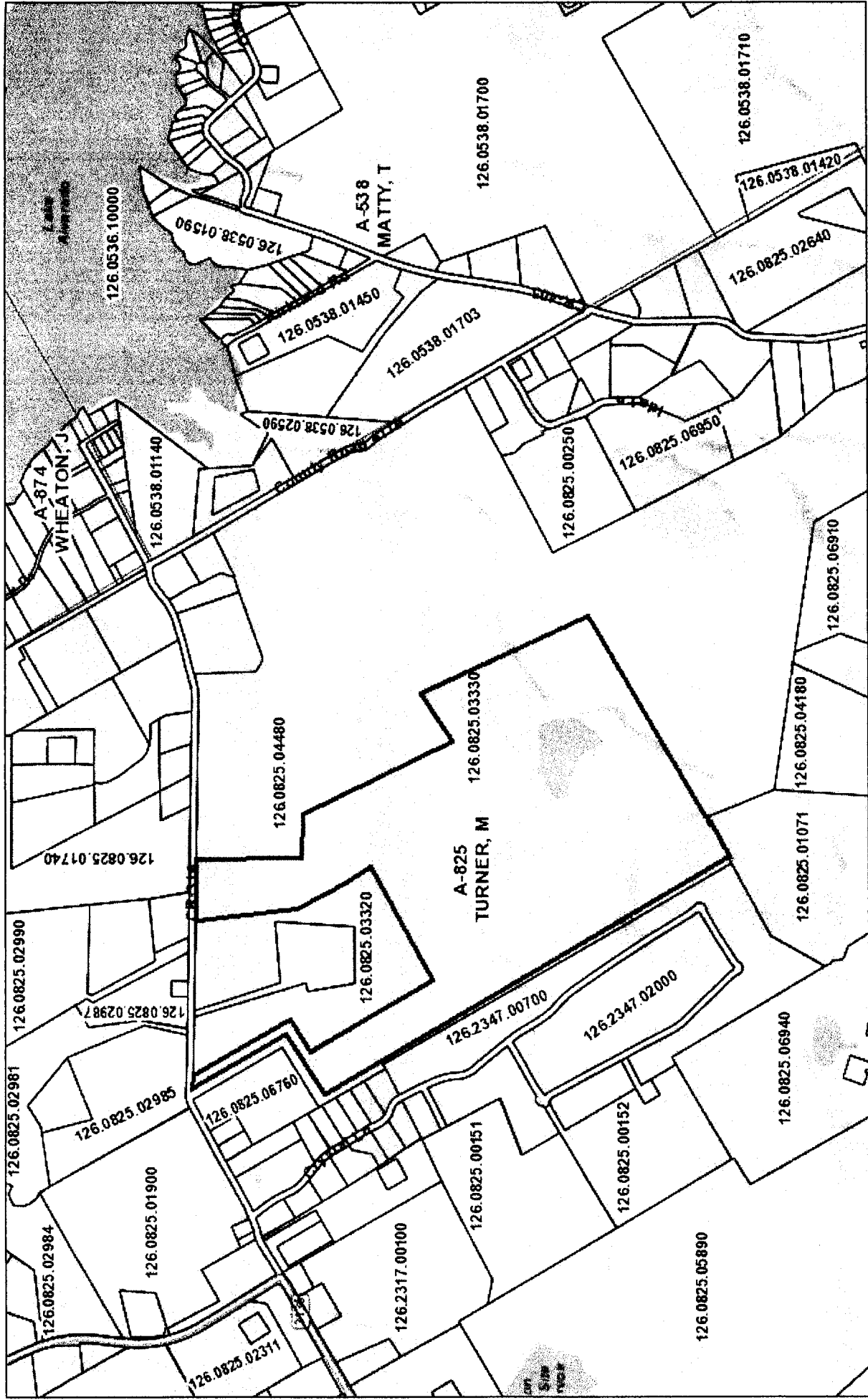

September 5, 2017

Disclaimer: This product is for informational purposes only and has not been prepared for or be suitable for legal, engineering, or surveying purposes. It does not represent an on-the-ground survey and represents only the approximate relative location of boundaries

1:18,056

- Parcels
- Abstracts

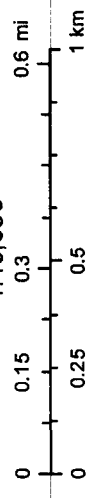

Sources: Esri, HERE, DeLorme, USGS, Intermap, INCREMENT P, NRCan, Esri Japan, MEIT, Esri China (Hong Kong), Esri Korea, Esri (Thailand),

Central Appraisal District of Johnson County & BIS Consulting - www.bisconsultants.com
 This product and relative contents are the property of the respective governmental entity and BIS Consultants. Use is restricted for official purposes.